

DGN

Set-back vortex impeller

All product images are indicative only



General characteristics

| Set-back vortex impeller | |
|--------------------------|---|
| motor power | 1,1 ÷ 4,1 kW |
| poles | 2 / 4 / 6 |
| discharge | GAS 2½" vertical DN65÷DN150 horizontal |
| free passage | max 150 mm |
| max flow rate | 46.4 l/s |
| max head | 22.3 m |

Electromechanical assembly

Electromechanical assembly in GJL-250 cast iron, for submerged operation. Seal set comprising 2 (two) opposing silicon carbide mechanical seals in inspectable oil sump. Ecological dry motor. Series available in ATEX explosion-proof version.

Applications

Used with unstrained soiled biological wastewaters and sewage and for civil lifting applications. It is thus ideal for wastewater treatment plants, sewer systems, livestock farms, industry and agriculture. This series is prefitted for installation of the ZENIT cooling system for dry or semi-submerged installation.

Construction materials

| | |
|----------------------------------|--|
| Case | Cast iron EN-GJL 250 |
| Impeller | Cast iron EN-GJL-250 |
| Nuts and bolts | Stainless steel - Class A2-70 |
| Standard gasket | Rubber - NBR |
| Shaft | Stainless steel - AISI 420 |
| Cooling jacket | Stainless steel - AISI 304 |
| Paint type | Ecological bicomponent epoxy (medium thickness 150 µm) |
| Set of standard mechanical seals | Two silicon carbide mechanical seals (2SiC) |

Operating limits

| | |
|-------------------------------|----------------------|
| Maximum operating temperature | 40 °C |
| PH of treated fluid | 6 ÷ 14 |
| Viscosity of treated fluid | 1 mm ² /s |
| Maximum immersion depth | 20 m |
| Density of treated fluid | 1 Kg/dm ³ |
| Maximum acoustic pressure | 70 dB |
| max starts per hour | 30 |

DGN



Cooling system

Dry installation available using the cooling jacket (see details to page 17)



Cable Gland

Cable gland system to guarantee perfect water-tightness. The GAS thread ring-nut can be removed to fix a rigid or flexible duct to the cable gland to protect the power supply cable



Mechanical seals

Two silicon carbide (2SiC) mechanical seals in oil sump



Oil sump

Large oil sump to guarantee longer mechanical seal lifetime. A threaded flange can be easily removed to replace the mechanical seals



Drive shaft

Impeller connected to the drive shaft by means of tapered coupling



Free passage

Wide free passage allowing the expulsion of solids and preventing fouling of the impeller

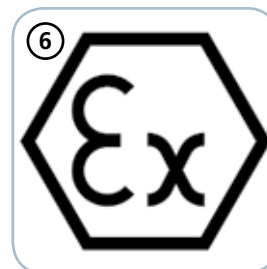

EX

Models available on request with ATEX certification, suitable for installation in the presence of potentially explosive gases, powders and liquids

CE 0496 Ex II 2GD Ex db k c IIB T5 Ex tb IIIC T100°C IP68

DGN

Models with vertical GAS 2½" threaded discharge - 2 poles

Performances

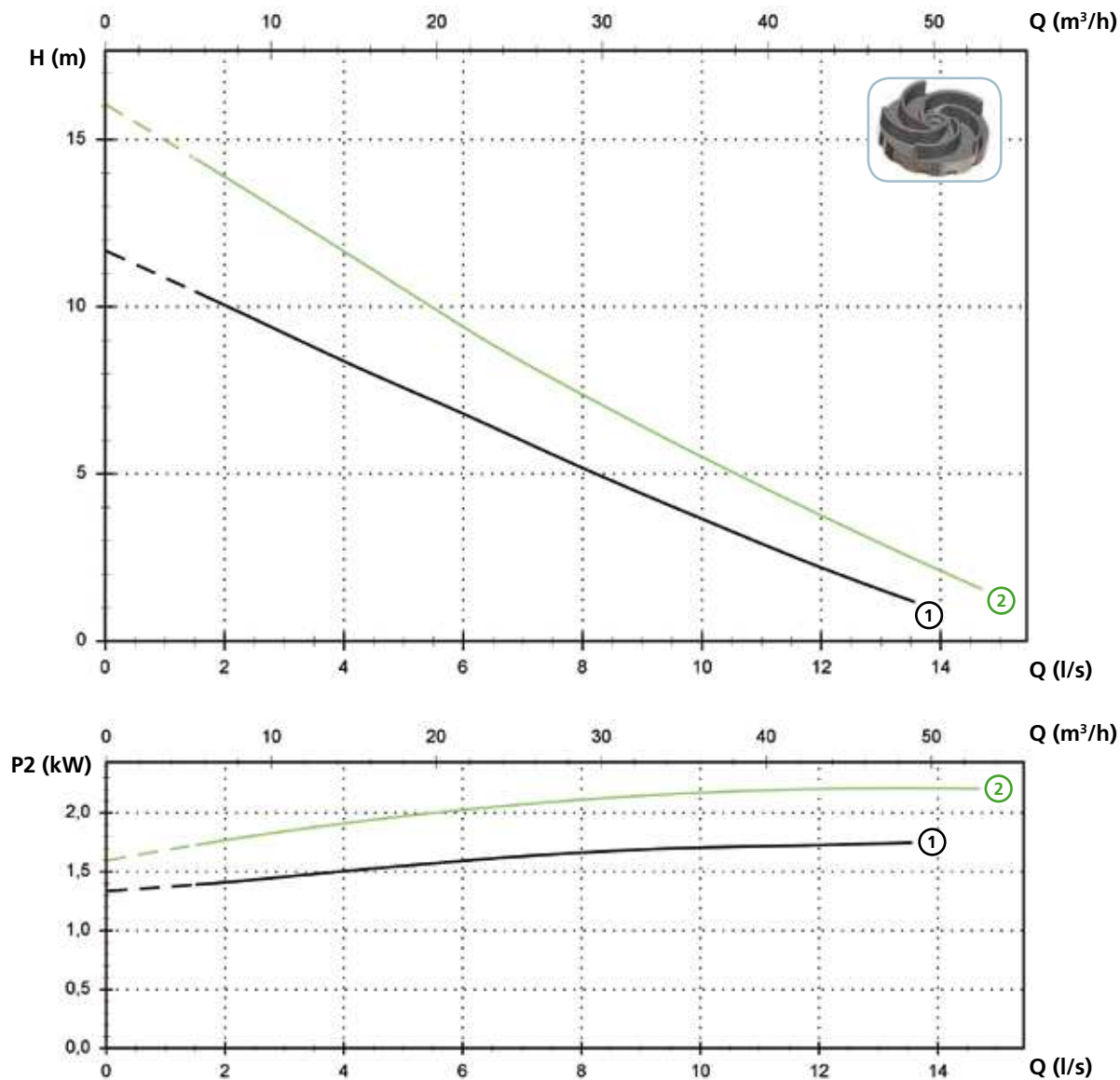

Technical data

| | V | Phases | P1 (kW) | P2 (kW) | A | Rpm | Start | Ø | Cable (*) | Free passage |
|--------------------------|-----|--------|---------|---------|------|------|-------|-------|-----------|--------------|
| ① DGN 250/2/G65V A1DM/50 | 230 | 1 | 2.8 | 1.8 | 12.5 | 2900 | Dir | G 2½" | A - B | 65 mm |
| ① DGN 250/2/G65V A1DT/50 | 400 | 3 | 2.5 | 1.8 | 4.3 | 2900 | Dir | G 2½" | A - B | 65 mm |
| ② DGN 300/2/G65V A1DT/50 | 400 | 3 | 2.9 | 2.2 | 5.1 | 2900 | Dir | G 2½" | A - B | 65 mm |

(*) A = 07RN-F 4G1.5+3x1 - 10 m (standard version). Electrical and mechanical features are equal to the cable H07RN-F
 B = NSSHOU-J 4G1.5+2x0.75 - 10 m (ATEX version)

Models with horizontal DN65 PN10-16 flanged discharge - 2 poles

Performances

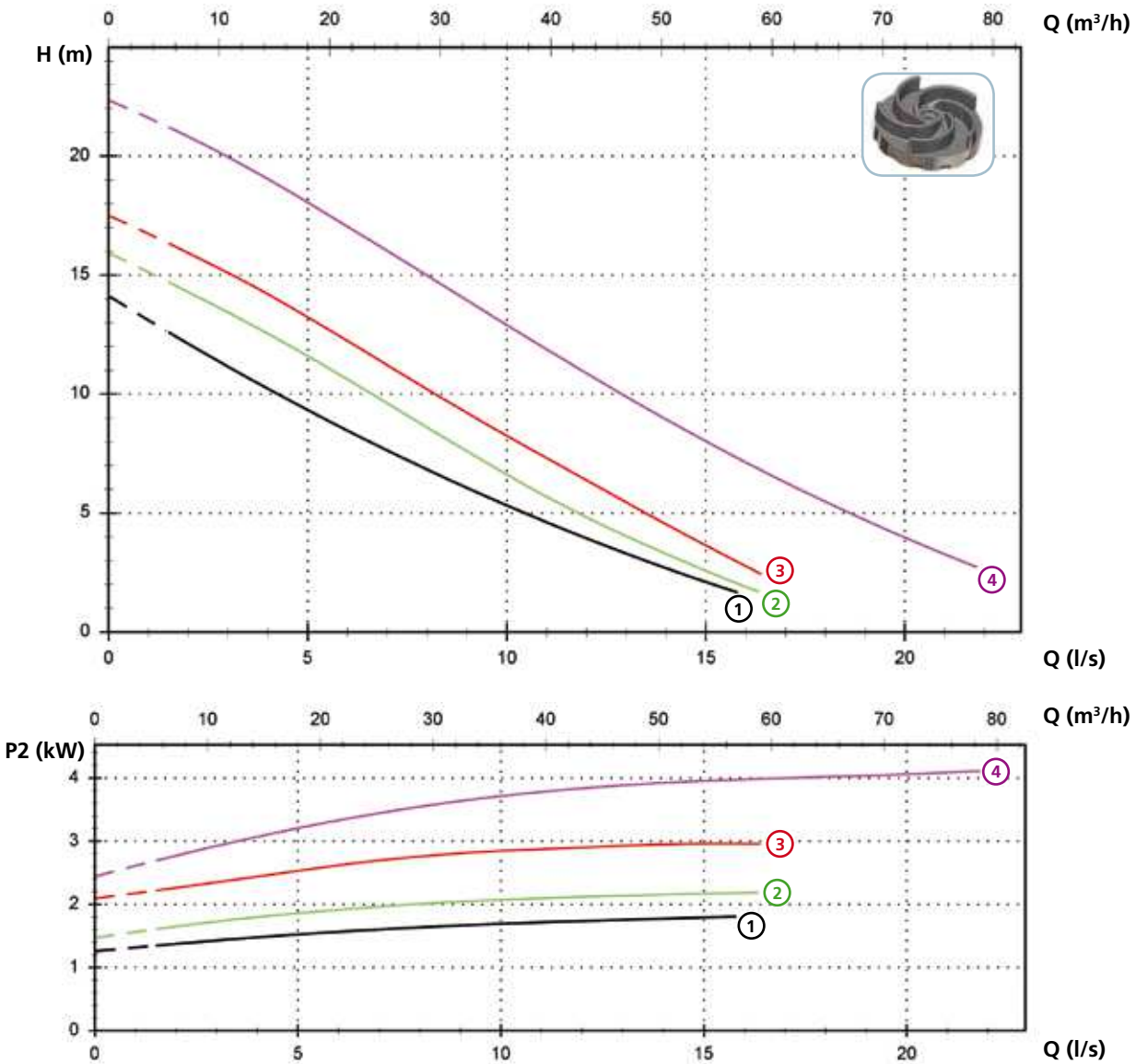

Technical data

| | V | Phases | P1 (kW) | P2 (kW) | A | Rpm | Start | Ø | Cable (*) | Free passage | |
|---|----------------------|--------|---------|---------|-----|------|-------|-----|--------------|--------------|-------|
| ① | DGN 250/2/65 A1DM/50 | 230 | 1 | 2.8 | 1.8 | 12.5 | 2900 | Dir | DN65 PN10-16 | A - B | 65 mm |
| ① | DGN 250/2/65 A1DT/50 | 400 | 3 | 2.5 | 1.8 | 4.3 | 2900 | Dir | DN65 PN10-16 | A - B | 65 mm |
| ② | DGN 300/2/65 A1DT/50 | 400 | 3 | 2.9 | 2.2 | 5.1 | 2900 | Dir | DN65 PN10-16 | A - B | 65 mm |
| ③ | DGN 400/2/65 A1FT/50 | 400 | 3 | 4.0 | 3 | 6.7 | 2900 | Dir | DN65 PN10-16 | A - C | 65 mm |
| ④ | DGN 550/2/65 A1FT/50 | 400 | 3 | 5.0 | 4.1 | 8.7 | 2900 | Dir | DN65 PN10-16 | A - C | 65 mm |

(*) A = 07RN-F 4G1.5+3x1 - 10 m (standard version). Electrical and mechanical features are equal to the cable H07RN-F
 B = NSSHOU-J 4G1.5+2x0.75 - 10 m (ATEX version)
 C = NSSHOU-J 4G2.5+2x0.75 - 10 m (ATEX version)



DGN

Models with horizontal DN80 PN10-16 flanged discharge - 2 poles

Performances

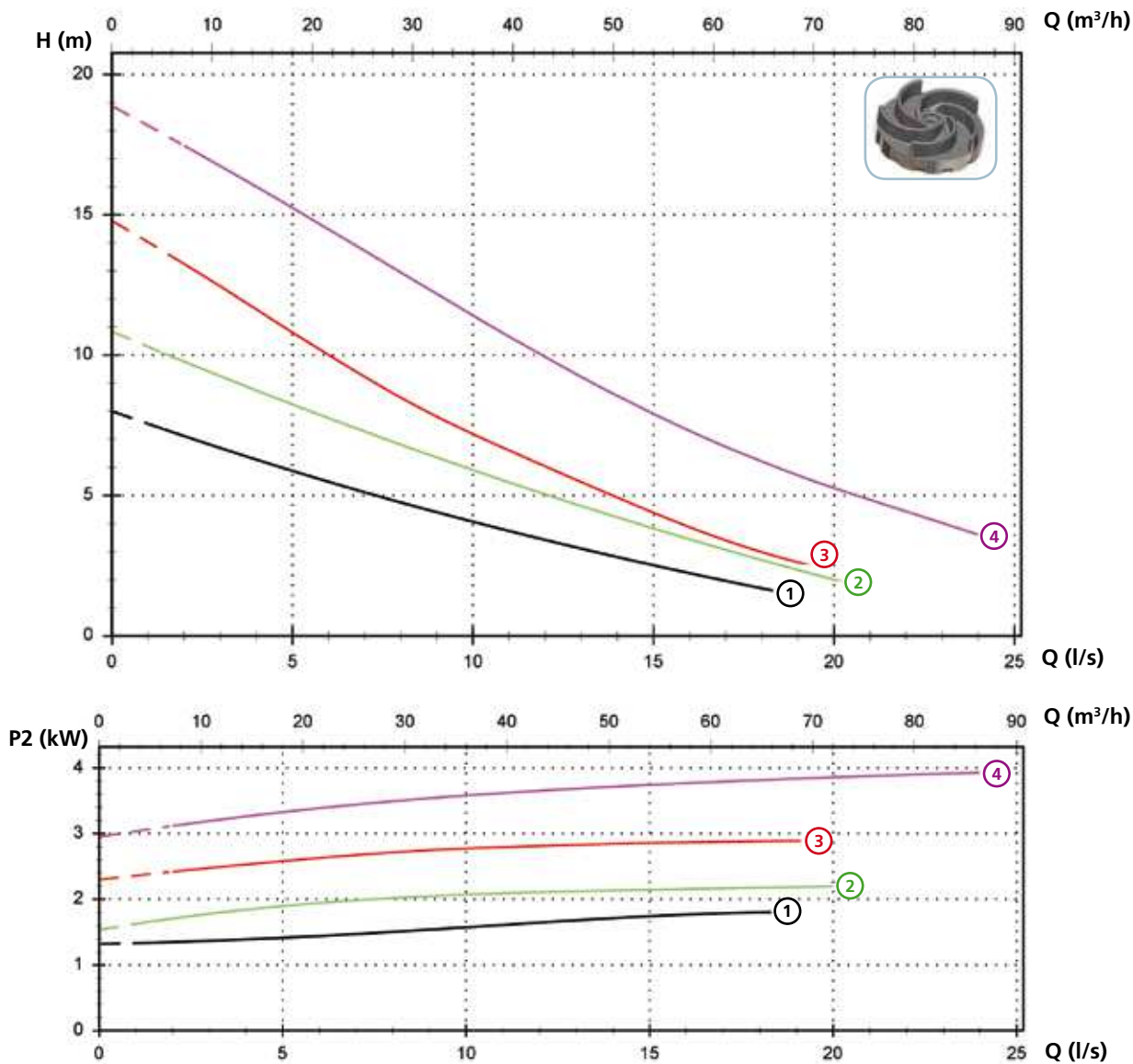

Technical data

| | V | Phases | P1 (kW) | P2 (kW) | A | Rpm | Start | Ø | Cable (*) | Free passage |
|------------------------|-----|--------|---------|---------|------|------|-------|--------------|-----------|--------------|
| ① DGN 250/2/80 A1DM/50 | 230 | 1 | 2.8 | 1.8 | 12.5 | 2900 | Dir | DN80 PN10-16 | A - B | 80 mm |
| ① DGN 250/2/80 A1DT/50 | 400 | 3 | 2.5 | 1.8 | 4.3 | 2900 | Dir | DN80 PN10-16 | A - B | 80 mm |
| ② DGN 300/2/80 A1DT/50 | 400 | 3 | 2.9 | 2.2 | 5.1 | 2900 | Dir | DN80 PN10-16 | A - B | 80 mm |
| ③ DGN 400/2/80 A1FT/50 | 400 | 3 | 4.0 | 3 | 6.7 | 2900 | Dir | DN80 PN10-16 | A - C | 80 mm |
| ④ DGN 550/2/80 A1FT/50 | 400 | 3 | 5.0 | 4.1 | 8.7 | 2900 | Dir | DN80 PN10-16 | A - C | 80 mm |

(*) A = 07RN-F 4G1.5+3x1 - 10 m (standard version). Electrical and mechanical features are equal to the cable H07RN-F
 B = NSSHOU-J 4G1.5+2x0.75 - 10 m (ATEX version)
 C = NSSHOU-J 4G2.5+2x0.75 - 10 m (ATEX version)

Models with horizontal DN65 PN10-16 flanged discharge - 4 poles

Performances

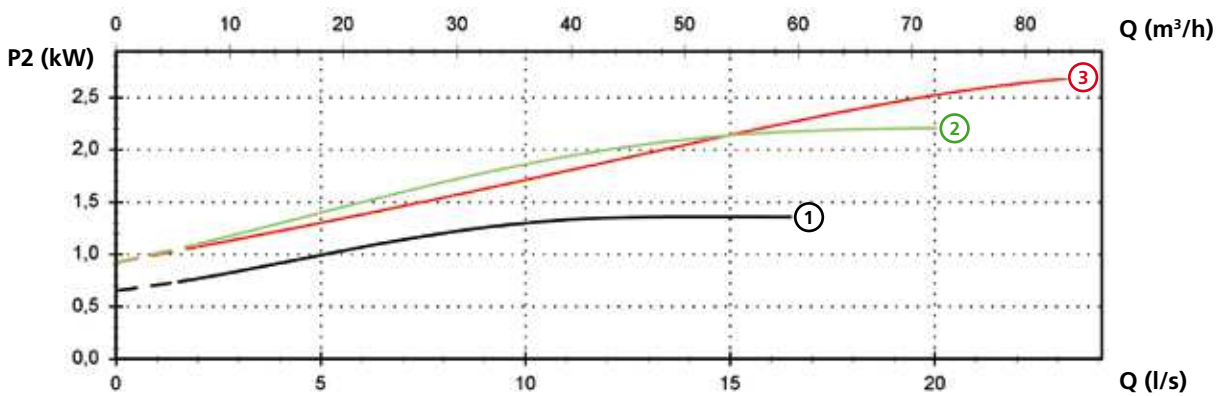
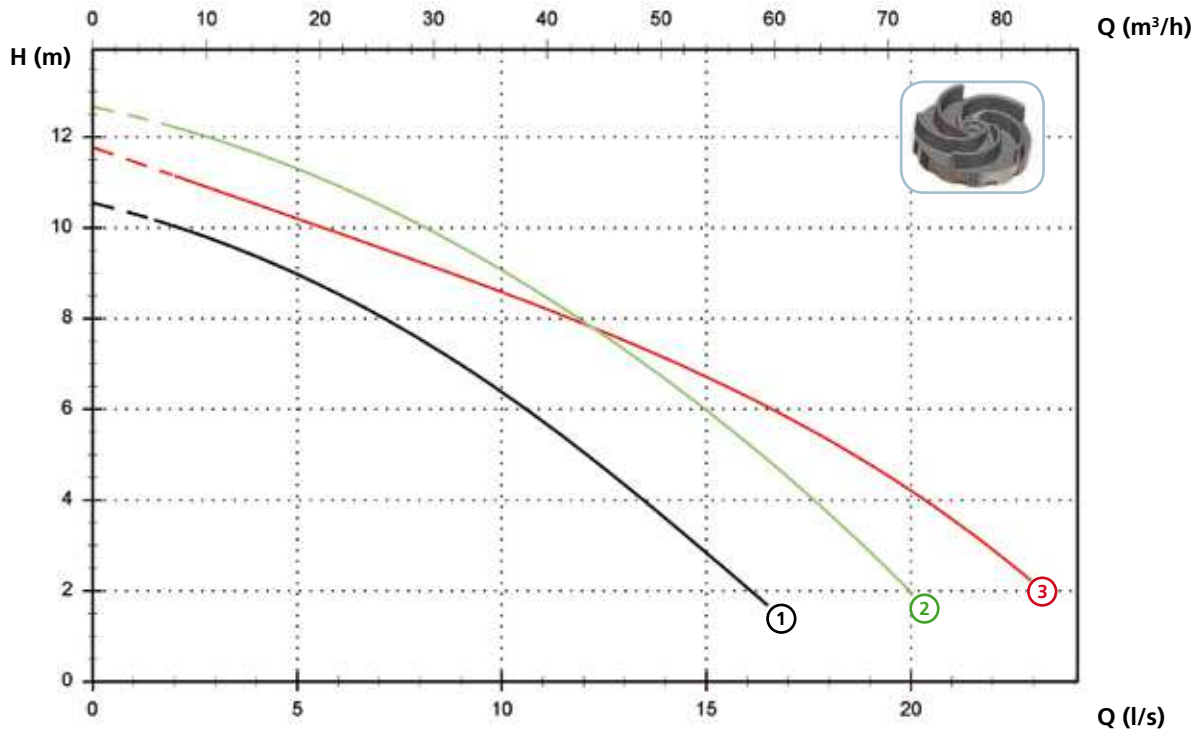

Technical data

| | V | Phases | P1 (kW) | P2 (kW) | A | Rpm | Start | Ø | Cable (*) | Free passage | |
|---|----------------------|--------|---------|---------|-----|-----|-------|-----|--------------|--------------|-------|
| ① | DGN 200/4/65 A1DT/50 | 400 | 3 | 2.0 | 1.5 | 4.1 | 1450 | Dir | DN65 PN10-16 | A - B | 65 mm |
| ② | DGN 300/4/65 A1FT/50 | 400 | 3 | 2.9 | 2.2 | 5.8 | 1450 | Dir | DN65 PN10-16 | A - C | 65 mm |
| ③ | DGN 400/4/65 A1FT/50 | 400 | 3 | 3.4 | 3 | 6.7 | 1450 | Dir | DN65 PN10-16 | A - C | 65 mm |

(*) A = 07RN-F 4G1.5+3x1 - 10 m (standard version). Electrical and mechanical features are equal to the cable H07RN-F
 B = NSSHOU-J 4G1.5+2x0.75 - 10 m (ATEX version)
 C = NSSHOU-J 4G2.5+2x0.75 - 10 m (ATEX version)

DGN

Models with horizontal DN80 PN10-16 flanged discharge - 4 poles

Performances

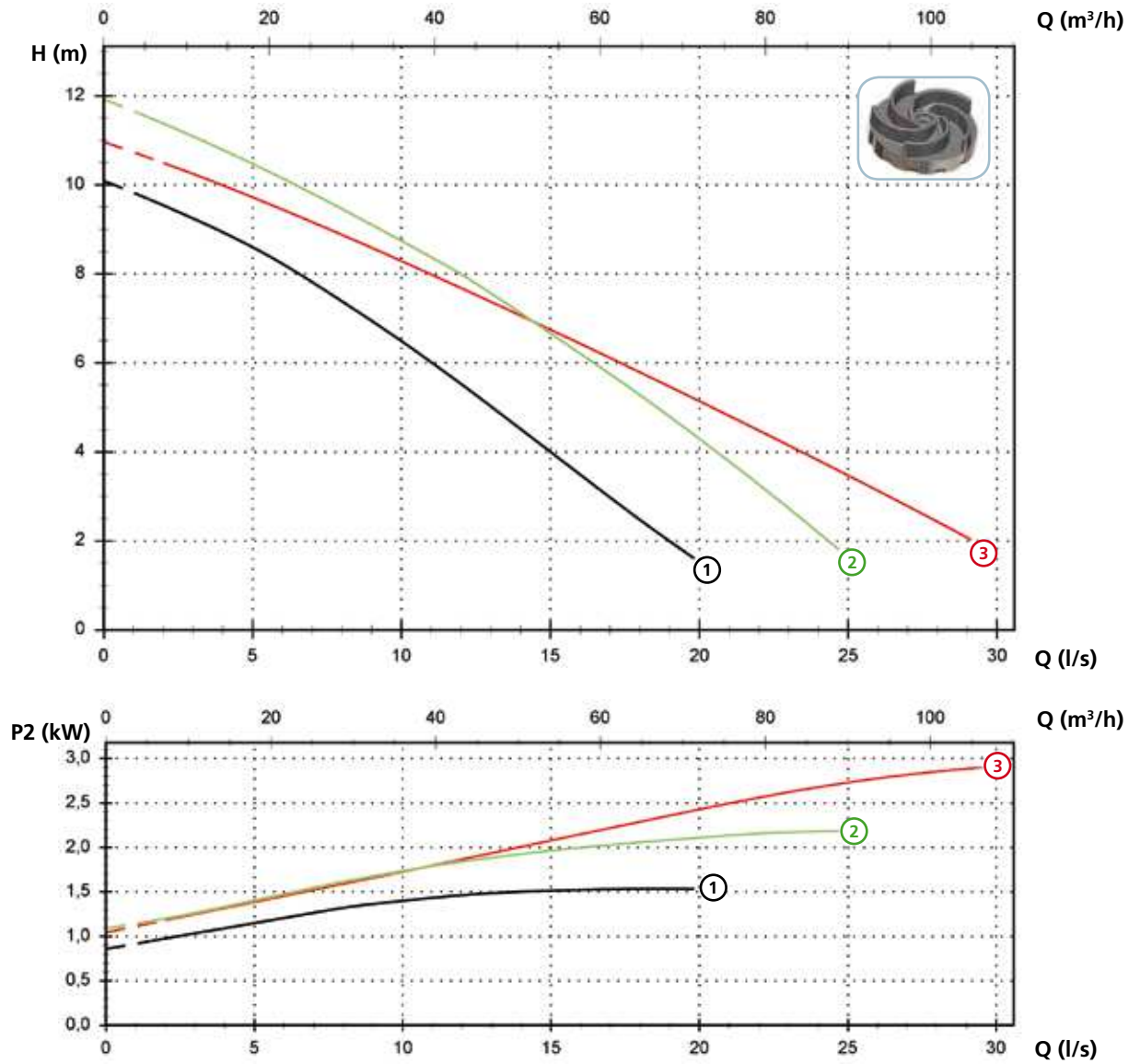

Technical data

| | V | Phases | P1 (kW) | P2 (kW) | A | Rpm | Start | Ø | Cable (*) | Free passage |
|------------------------|-----|--------|---------|---------|-----|------|-------|--------------|-----------|--------------|
| ① DGN 200/4/80 A1DT/50 | 400 | 3 | 2.0 | 1.5 | 4.1 | 1450 | Dir | DN80 PN10-16 | A - B | 80 mm |
| ② DGN 300/4/80 A1FT/50 | 400 | 3 | 2.9 | 2.2 | 5.8 | 1450 | Dir | DN80 PN10-16 | A - C | 80 mm |
| ③ DGN 400/4/80 A1FT/50 | 400 | 3 | 3.7 | 3 | 7.3 | 1450 | Dir | DN80 PN10-16 | A - C | 80 mm |

(*) A = 07RN-F 4G1.5+3x1 - 10 m (standard version). Electrical and mechanical features are equal to the cable H07RN-F
 B = NSSHOU-J 4G1.5+2x0.75 - 10 m (ATEX version)
 C = NSSHOU-J 4G2.5+2x0.75 - 10 m (ATEX version)

Models with horizontal DN100 PN10-16 flanged discharge - 4 poles

Performances

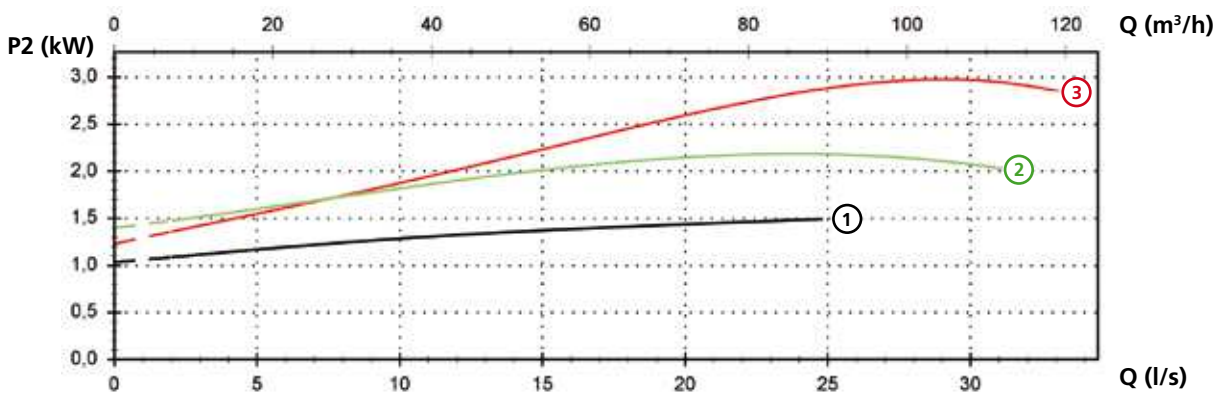
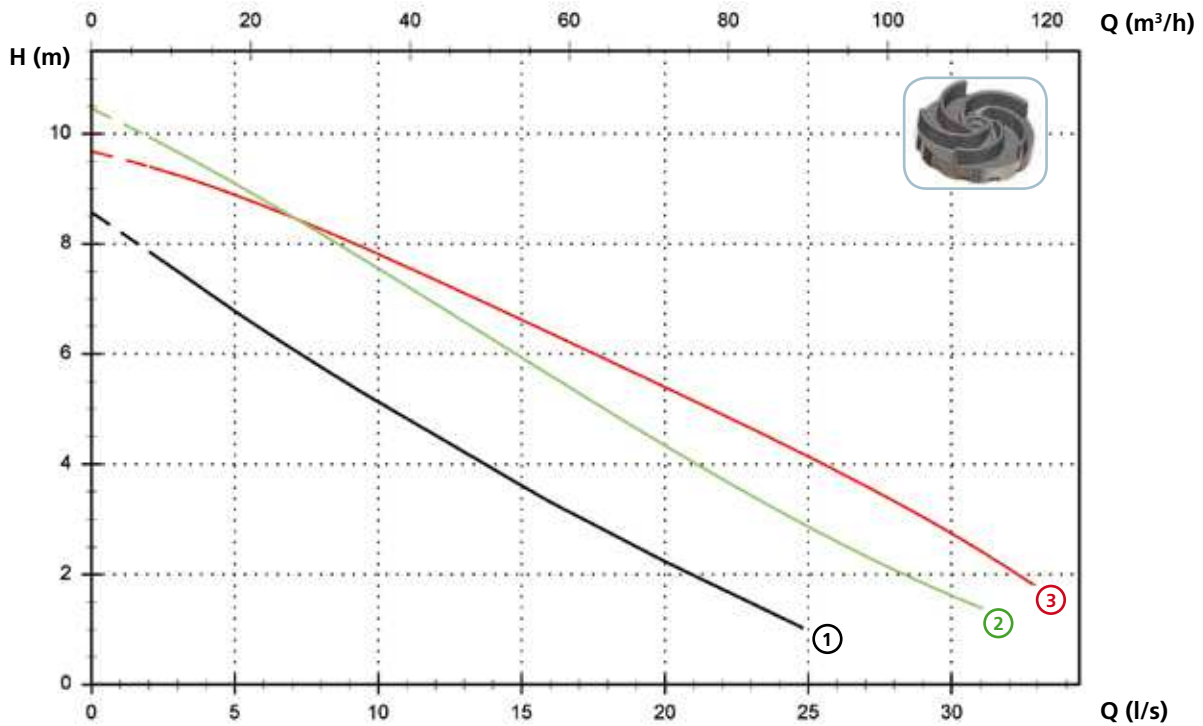

Technical data

| | V | Phases | P1 (kw) | P2 (kw) | A | Rpm | Start | Ø | Cable (*) | Free passage | |
|---|-----------------------|--------|---------|---------|-----|-----|-------|-----|---------------|--------------|--------|
| ① | DGN 200/4/100 A1DT/50 | 400 | 3 | 2.0 | 1.5 | 4.1 | 1450 | Dir | DN100 PN10-16 | A - B | 100 mm |
| ② | DGN 300/4/100 A1FT/50 | 400 | 3 | 2.9 | 2.2 | 5.8 | 1450 | Dir | DN100 PN10-16 | A - C | 100 mm |
| ③ | DGN 400/4/100 A1FT/50 | 400 | 3 | 3.7 | 3 | 7.3 | 1450 | Dir | DN100 PN10-16 | A - C | 100 mm |

(*) A = 07RN-F 4G1.5+3x1 - 10 m (standard version). Electrical and mechanical features are equal to the cable H07RN-F
 B = NSSHOU-J 4G1.5+2x0.75 - 10 m (ATEX version)
 C = NSSHOU-J 4G2.5+2x0.75 - 10 m (ATEX version)

DGN

Models with horizontal DN65 PN10-16 flanged discharge - 6 poles

Performances

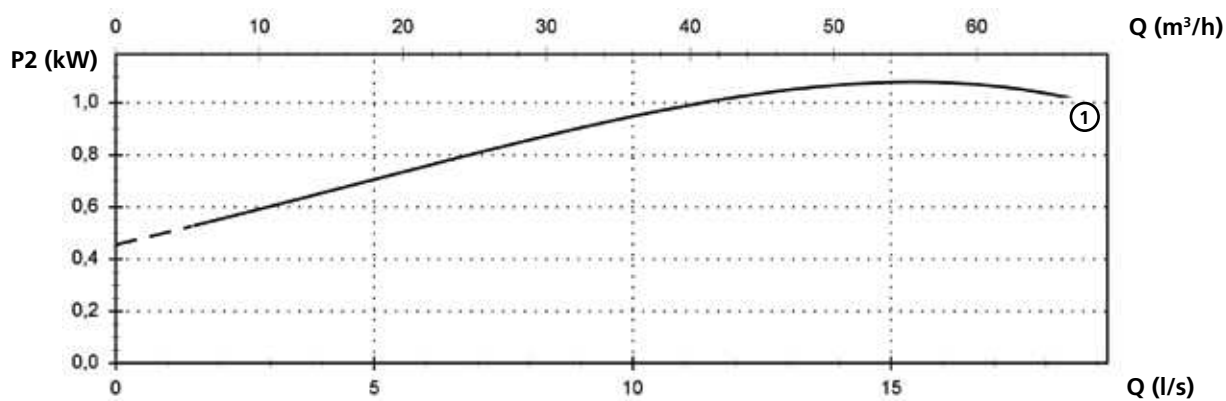
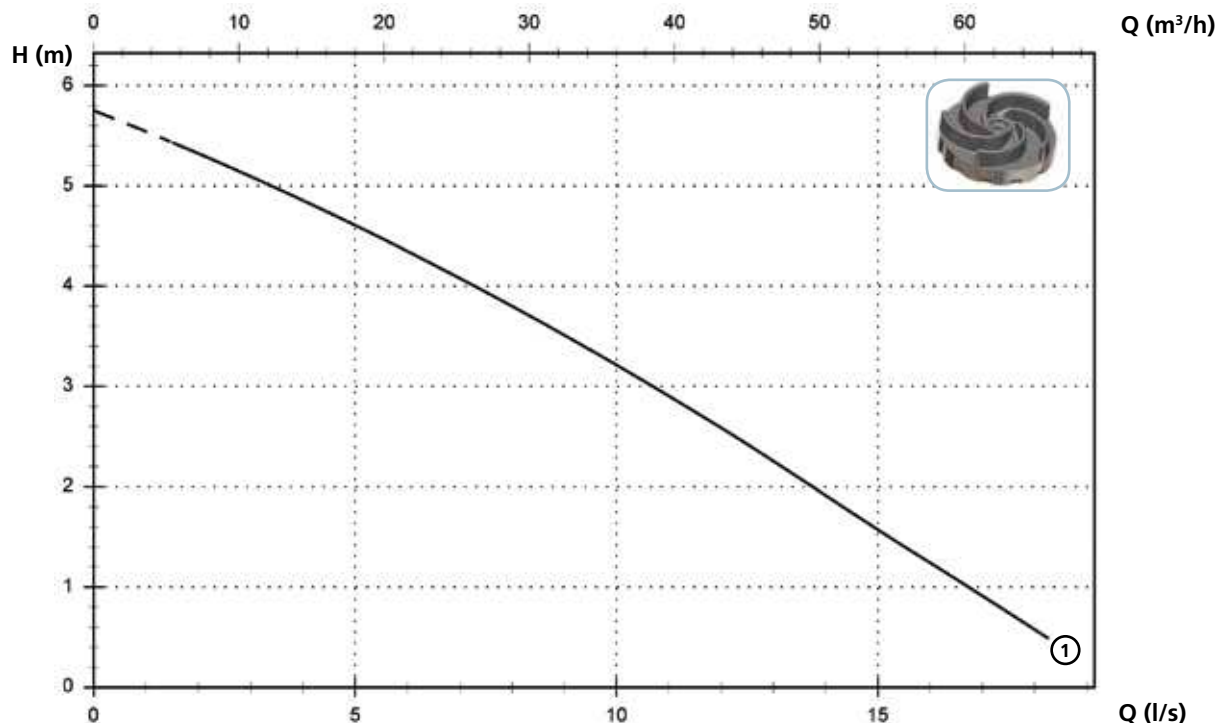

Technical data

| | V | Phases | P1 (kW) | P2 (kW) | A | Rpm | Start | Ø | Cable (*) | Free passage |
|------------------------|-----|--------|---------|---------|-----|-----|-------|--------------|-----------|--------------|
| ① DGN 150/6/65 A1DT/50 | 400 | 3 | 1.6 | 1.1 | 3.7 | 960 | Dir | DN65 PN10-16 | A - B | 65 mm |

(*) A = 07RN-F 4G1.5+3x1 - 10 m (standard version). Electrical and mechanical features are equal to the cable H07RN-F
 B = NSSHOU-J 4G1.5+2x0.75 - 10 m (ATEX version)

Models with horizontal DN80 PN10-16 flanged discharge - 6 poles

Performances

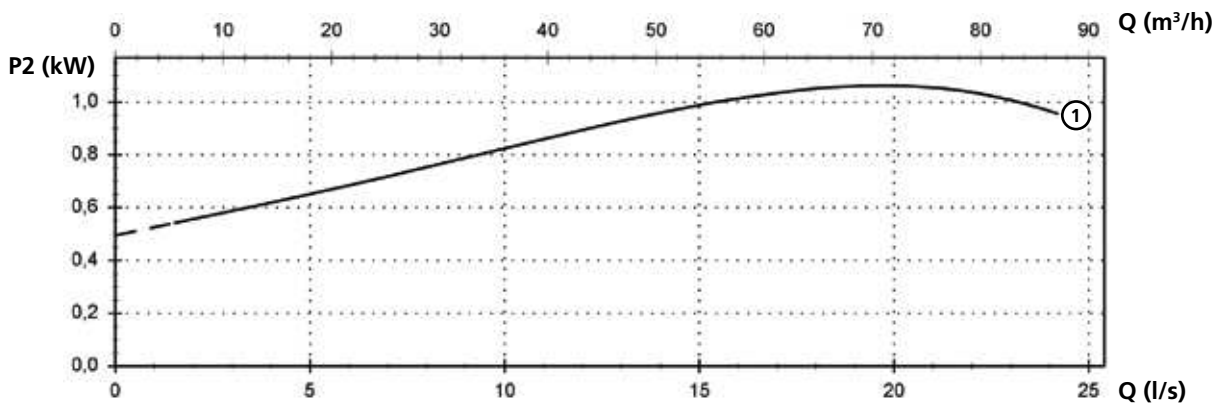
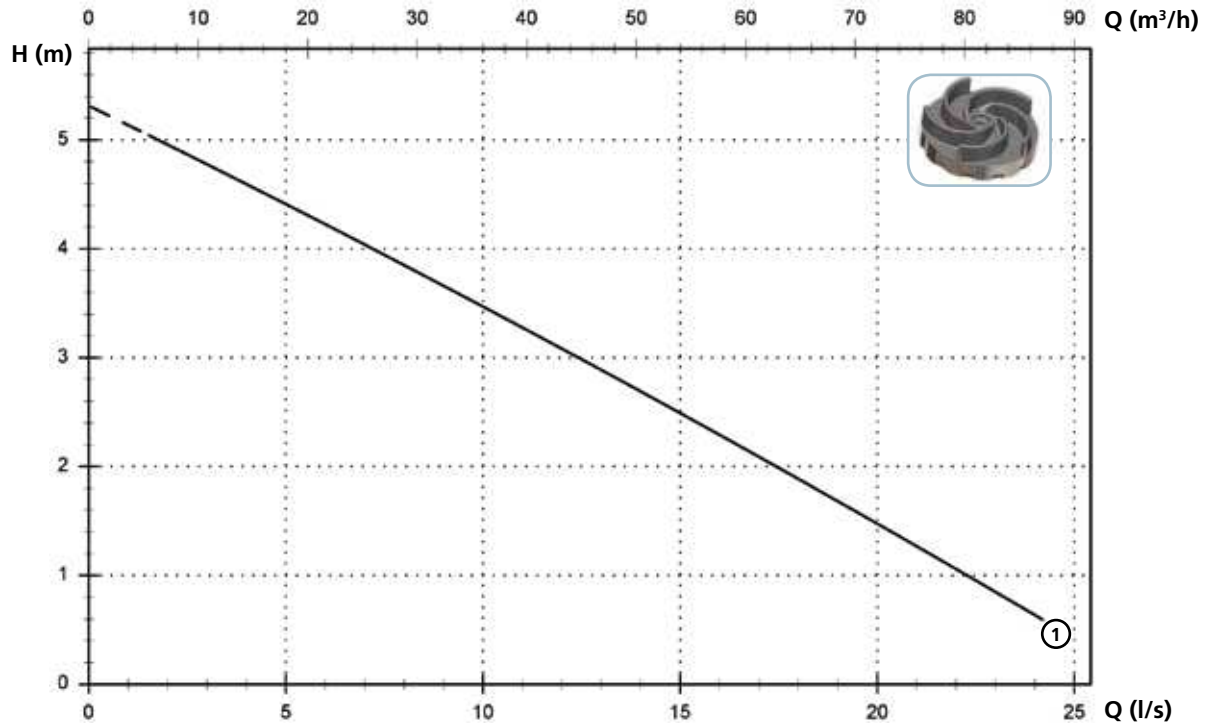

Technical data

| | V | Phases | P1 (kW) | P2 (kW) | A | Rpm | Start | Ø | Cable (*) | Free passage |
|------------------------|-----|--------|---------|---------|-----|-----|-------|--------------|-----------|--------------|
| ① DGN 150/6/80 A1DT/50 | 400 | 3 | 1.6 | 1.1 | 3.7 | 960 | Dir | DN80 PN10-16 | A - B | 80 mm |

(*) A = 07RN-F 4G1.5+3x1 - 10 m (standard version). Electrical and mechanical features are equal to the cable H07RN-F
 B = NSSHOU-J 4G1.5+2x0.75 - 10 m (ATEX version)

DGN

Models with horizontal DN100 PN10-16 flanged discharge - 6 poles

Performances

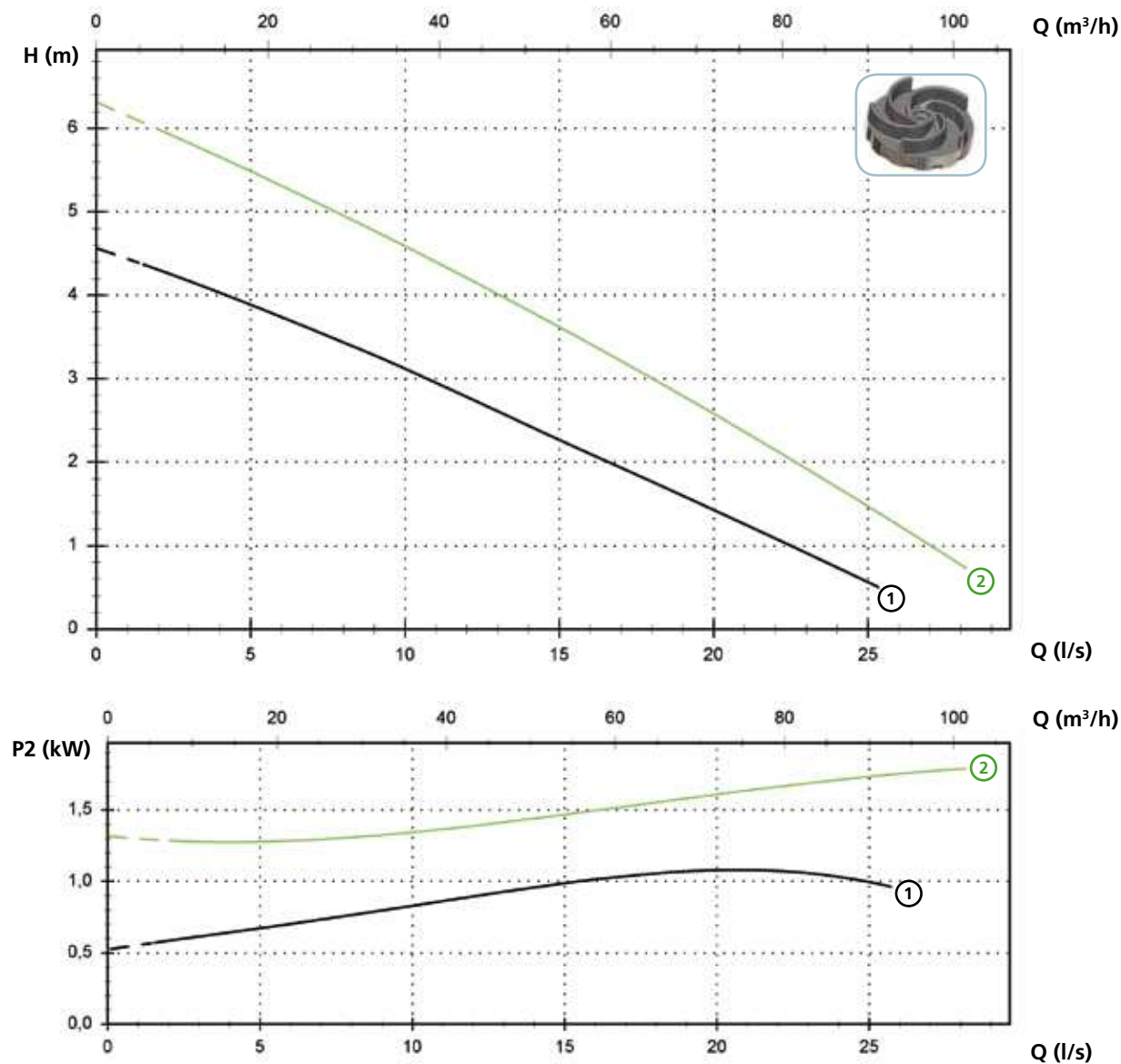

Technical data

| | V | Phases | P1 (kW) | P2 (kW) | A | Rpm | Start | Ø | Cable (*) | Free passage | |
|---|-----------------------|--------|---------|---------|-----|-----|-------|-----|---------------|--------------|--------|
| ① | DGN 150/6/100 A1DT/50 | 400 | 3 | 1.6 | 1.1 | 3.7 | 960 | Dir | DN100 PN10-16 | A - B | 100 mm |
| ② | DGN 250/6/100 A1FT/50 | 400 | 3 | 2.6 | 1.8 | 5.7 | 960 | Dir | DN100 PN10-16 | A - C | 100 mm |

(*) A = 07RN-F 4G1.5+3x1 - 10 m (standard version). Electrical and mechanical features are equal to the cable H07RN-F
 B = NSSHOU-J 4G1.5+2x0.75 - 10 m (ATEX version)
 C = NSSHOU-J 4G2.5+2x0.75 - 10 m (ATEX version)

Models with horizontal DN150 PN10-16 flanged discharge - 6 poles

Performances

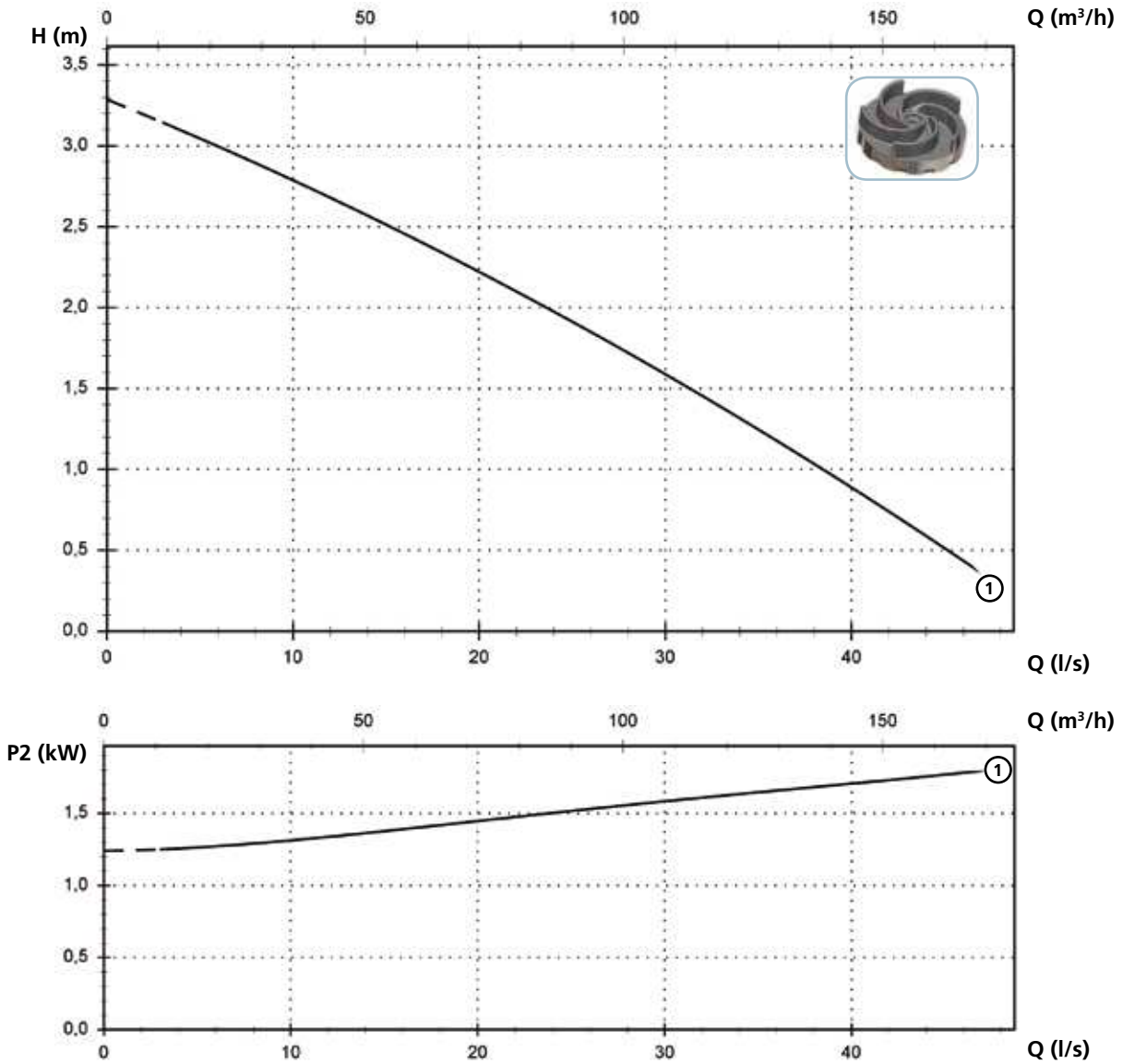

Technical data

| | V | Phases | P1 (kW) | P2 (kW) | A | Rpm | Start | Ø | Cable (*) | Free passage | |
|---|-----------------------|--------|---------|---------|-----|-----|-------|-----|---------------|--------------|--------|
| ① | DGN 250/6/150 A1FT/50 | 400 | 3 | 2.6 | 1.8 | 5.7 | 960 | Dir | DN150 PN10-16 | A - B | 150 mm |

(*) A = 07RN-F 4G1.5+3x1 - 10 m (standard version). Electrical and mechanical features are equal to the cable H07RN-F
 B = NSSHOU-J 4G2.5+2x0.75 - 10 m (ATEX version)

DGN

Versions available

(Key to versions on page 16)

| | Electrical variants | | | | | | | | | | | Cooling | | | | Mechanical seals | | | | |
|------------------------|---------------------|---|--------|-------------|------------------|-----------------------|-------------|------------------|-----------------------|--------|--------|-------------|---|-----------|----|------------------|------|------|-------|--------|
| | N A E | T | T C | T C D | T C D T | T C D G T | T C G | T C S T | T C S G T | T S | T R | T R G | N | CC CCE | FT | C G F T | 2SIC | SICM | SICAL | 2SICAL |
| DGN 250/2/G65V A1DM/50 | | | | ● | | | | | | | | | ● | ● | | | ● | | | |
| DGN 250/2/G65V A1DT/50 | | ● | | | | | | | | ● | | | ● | ● | | | ● | | | |
| DGN 300/2/G65V A1DT/50 | | ● | | | | | | | | ● | | | ● | ● | | | ● | | | |
| DGN 250/2/65 A1DM/50 | | | | ● | | | | | | | | | ● | ● | | | ● | | | |
| DGN 250/2/65 A1DT/50 | | ● | | | | | | | | ● | | | ● | ● | | | ● | | | |
| DGN 300/2/65 A1DT/50 | | ● | | | | | | | | ● | | | ● | ● | | | ● | | | |
| DGN 400/2/65 A1FT/50 | | ● | | | | | | | | ● | | | ● | ● | | | ● | | | |
| DGN 550/2/65 A1FT/50 | | ● | | | | | | | | ● | | | ● | ● | | | ● | | | |
| DGN 250/2/80 A1DM/50 | | | | ● | | | | | | | | | ● | ● | | | ● | | | |
| DGN 250/2/80 A1DT/50 | | ● | | | | | | | | ● | | | ● | ● | | | ● | | | |
| DGN 300/2/80 A1DT/50 | | ● | | | | | | | | ● | | | ● | ● | | | ● | | | |
| DGN 400/2/80 A1FT/50 | | ● | | | | | | | | ● | | | ● | ● | | | ● | | | |
| DGN 550/2/80 A1FT/50 | | ● | | | | | | | | ● | | | ● | ● | | | ● | | | |
| DGN 200/4/65 A1DT/50 | | ● | | | | | | | | ● | | | ● | ● | | | ● | | | |
| DGN 300/4/65 A1FT/50 | | ● | | | | | | | | ● | | | ● | ● | | | ● | | | |
| DGN 400/4/65 A1FT/50 | | ● | | | | | | | | ● | | | ● | ● | | | ● | | | |
| DGN 200/4/80 A1DT/50 | | ● | | | | | | | | ● | | | ● | ● | | | ● | | | |
| DGN 300/4/80 A1FT/50 | | ● | | | | | | | | ● | | | ● | ● | | | ● | | | |
| DGN 400/4/80 A1FT/50 | | ● | | | | | | | | ● | | | ● | ● | | | ● | | | |
| DGN 200/4/100 A1DT/50 | | ● | | | | | | | | ● | | | ● | ● | | | ● | | | |
| DGN 300/4/100 A1FT/50 | | ● | | | | | | | | ● | | | ● | ● | | | ● | | | |
| DGN 400/4/100 A1FT/50 | | ● | | | | | | | | ● | | | ● | ● | | | ● | | | |
| DGN 150/6/65 A1DT/50 | | ● | | | | | | | | ● | | | ● | ● | | | ● | | | |
| DGN 150/6/80 A1DT/50 | | ● | | | | | | | | ● | | | ● | ● | | | ● | | | |
| DGN 150/6/100 A1DT/50 | | ● | | | | | | | | ● | | | ● | ● | | | ● | | | |
| DGN 250/6/100 A1FT/50 | | ● | | | | | | | | ● | | | ● | ● | | | ● | | | |
| DGN 250/6/150 A1FT/50 | | ● | | | | | | | | ● | | | ● | ● | | | ● | | | |

NOTE FOR SINGLE PHASE PUMPS: thermal protections into the winding have to be connected to the electrical panel.
 Start capacitor inside the pump. Circuit breaker supplied but not connected to the pump cable.
 The use of an electrical panel as circuit breaker housing is mandatory.
 For installation please see use and maintenance instructions booklet.



Overall dimensions and weights

Models with vertical discharge

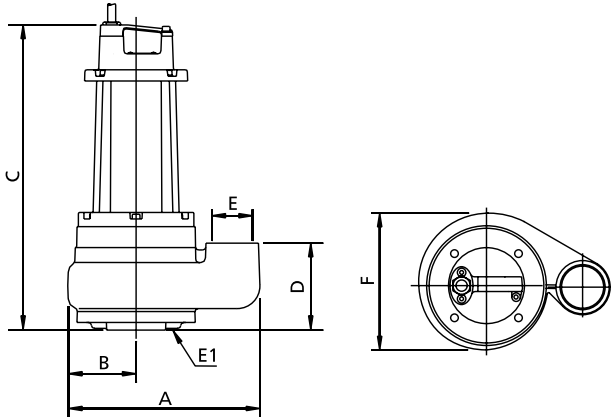

Models with horizontal discharge

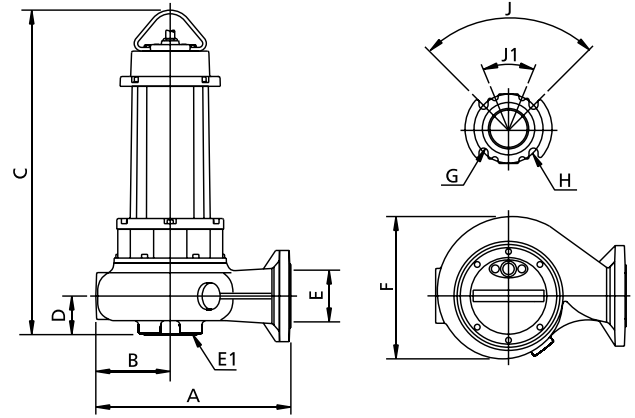

| | A | B | C | D | E | E1 (*) | F | G | H | J | J1 | kg |
|---------------------------|-----|-----|-----|-----|----------|--------|-----|----|-----|-----|-----|-----|
| DGN 250/2/G65V A1DM(T)/50 | 310 | 110 | 560 | 135 | G 2 1/2" | 65 | 220 | - | - | - | - | 49 |
| DGN 300/2/G65V A1DT/50 | 310 | 110 | 560 | 135 | G 2 1/2" | 65 | 220 | - | - | - | - | 51 |
| DGN 250/2/65 A1DM(T)/50 | 300 | 120 | 560 | 60 | 65 | 65 | 220 | 18 | 145 | 90° | - | 51 |
| DGN 300/2/65 A1DT/50 | 320 | 130 | 580 | 80 | 65 | 65 | 250 | 18 | 145 | 90° | - | 53 |
| DGN 400/2/65 A1FT/50 | 320 | 130 | 720 | 80 | 65 | 65 | 250 | 18 | 145 | 90° | - | 74 |
| DGN 550/2/65 A1FT/50 | 320 | 130 | 720 | 80 | 65 | 65 | 250 | 18 | 145 | 90° | - | 78 |
| DGN 250/2/80 A1DM(T)/50 | 310 | 120 | 585 | 80 | 80 | 80 | 230 | 18 | 160 | 90° | 45° | 53 |
| DGN 300/2/80 A1DT/50 | 315 | 125 | 585 | 80 | 80 | 80 | 245 | 18 | 160 | 90° | 45° | 55 |
| DGN 400/2/80 A1FT/50 | 315 | 125 | 725 | 80 | 80 | 80 | 245 | 18 | 160 | 90° | 45° | 75 |
| DGN 550/2/80 A1FT/50 | 315 | 125 | 725 | 80 | 80 | 80 | 245 | 18 | 160 | 90° | 45° | 79 |
| DGN 200/4/65 A1DT/50 | 390 | 155 | 595 | 70 | 65 | 65 | 305 | 18 | 145 | 90° | - | 63 |
| DGN 300/4/65 A1FT/50 | 390 | 155 | 700 | 70 | 65 | 65 | 305 | 18 | 145 | 90° | - | 78 |
| DGN 400/4/65 A1FT/50 | 390 | 155 | 700 | 70 | 65 | 65 | 305 | 18 | 145 | 90° | - | 82 |
| DGN 200/4/80 A1DT/50 | 385 | 155 | 610 | 80 | 80 | 80 | 300 | 18 | 160 | 90° | 45° | 64 |
| DGN 300/4/80 A1FT/50 | 385 | 155 | 720 | 80 | 80 | 80 | 300 | 18 | 160 | 90° | 45° | 79 |
| DGN 400/4/80 A1FT/50 | 385 | 155 | 720 | 80 | 80 | 80 | 300 | 18 | 160 | 90° | 45° | 83 |
| DGN 200/4/100 A1DT/50 | 410 | 160 | 635 | 90 | 100 | 100 | 305 | 18 | 180 | 45° | - | 66 |
| DGN 300/4/100 A1FT/50 | 410 | 160 | 740 | 90 | 100 | 100 | 305 | 18 | 180 | 45° | - | 81 |
| DGN 400/4/100 A1FT/50 | 410 | 160 | 740 | 90 | 100 | 100 | 305 | 18 | 180 | 45° | - | 85 |
| DGN 150/6/65 A1DT/50 | 390 | 155 | 595 | 70 | 65 | 65 | 305 | 18 | 145 | 90° | - | 61 |
| DGN 150/6/80 A1DT/50 | 385 | 155 | 610 | 80 | 80 | 80 | 300 | 18 | 160 | 90° | 45° | 62 |
| DGN 150/6/100 A1DT/50 | 410 | 160 | 635 | 90 | 100 | 100 | 305 | 18 | 180 | 45° | - | 66 |
| DGN 250/6/100 A1FT/50 | 495 | 190 | 770 | 90 | 100 | 100 | 375 | 18 | 180 | 45° | - | 111 |
| DGN 250/6/150 A1FT/50 | 550 | 215 | 825 | 120 | 150 | 150 | 400 | 24 | 240 | 45° | - | 114 |

Dimensions in mm

(*) DN of the suction flange - PN6

All weights and dimensions are indicative only

DGN

Packaging dimension

| | A | B | C |
|---------------------------|-----|-----|-----|
| DGN 250/2/G65V A1DM(T)/50 | 725 | 555 | 415 |
| DGN 300/2/G65V A1DT/50 | 725 | 555 | 415 |
| DGN 250/2/65 A1DM(T)/50 | 725 | 555 | 415 |
| DGN 300/2/65 A1DT/50 | 725 | 555 | 415 |
| DGN 400/2/65 A1FT/50 | 915 | 515 | 555 |
| DGN 550/2/65 A1FT/50 | 915 | 515 | 555 |
| DGN 250/2/80 A1DM(T)/50 | 725 | 445 | 415 |
| DGN 300/2/80 A1DT/50 | 725 | 445 | 415 |
| DGN 400/2/80 A1FT/50 | 915 | 515 | 555 |
| DGN 550/2/80 A1FT/50 | 915 | 515 | 555 |
| DGN 200/4/65 A1DT/50 | 725 | 445 | 415 |
| DGN 300/4/65 A1FT/50 | 915 | 515 | 555 |
| DGN 400/4/65 A1FT/50 | 915 | 515 | 555 |
| DGN 200/4/80 A1DT/50 | 725 | 445 | 415 |
| DGN 300/4/80 A1FT/50 | 915 | 515 | 555 |
| DGN 400/4/80 A1FT/50 | 915 | 515 | 555 |
| DGN 200/4/100 A1DT/50 | 725 | 445 | 415 |
| DGN 300/4/100 A1FT/50 | 915 | 515 | 555 |
| DGN 400/4/100 A1FT/50 | 915 | 515 | 555 |
| DGN 150/6/65 A1DT/50 | 915 | 515 | 555 |
| DGN 150/6/80 A1DT/50 | 915 | 515 | 555 |
| DGN 150/6/100 A1DT/50 | 915 | 515 | 555 |
| DGN 250/6/100 A1FT/50 | 915 | 515 | 555 |
| DGN 250/6/150 A1FT/50 | 915 | 515 | 555 |

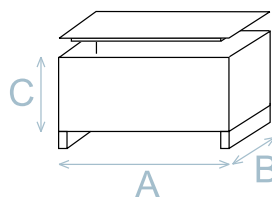

Dimension in mm

All weights and dimensions are indicative only

Installations available

