

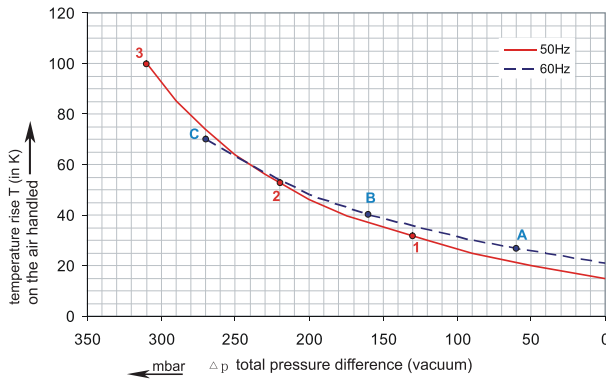

# 1RSC 61-100

Performance curve for Vacuum pump

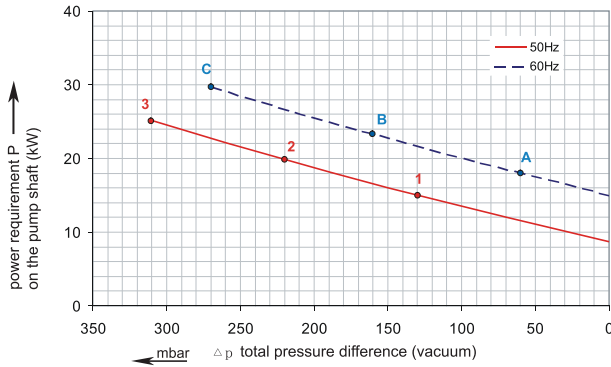
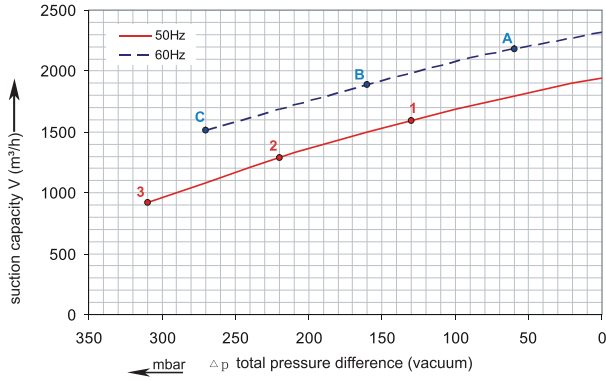

# 1RSC 61-100

Performance curve for Compressor

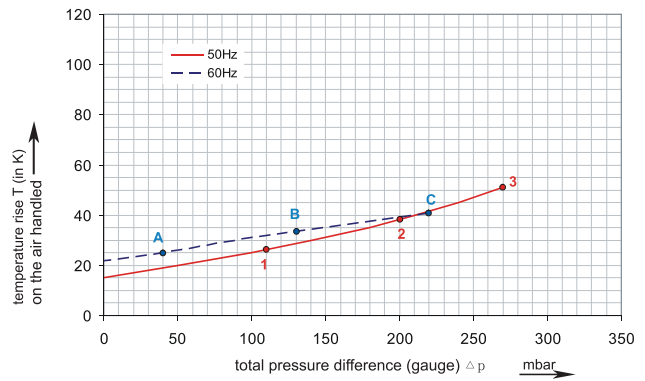
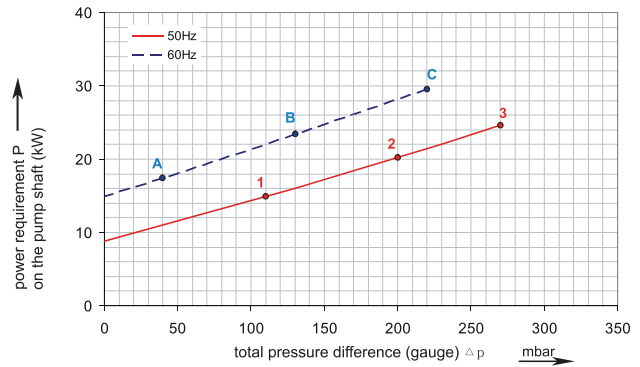
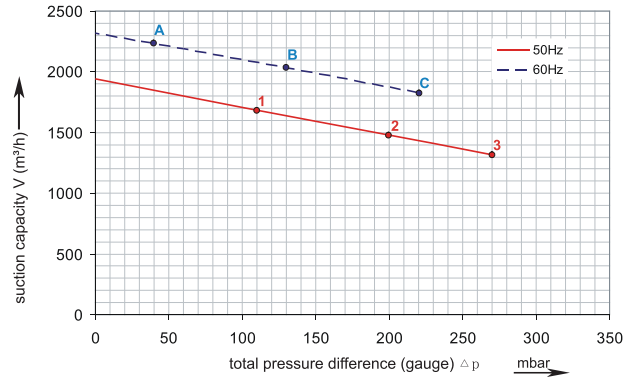

The performance curves are based on air at a temperature of 15 °C and an atmospheric pressure of 1013 mbar with a tolerance of +/- 10 %. The total pressure differences are valid for suction and ambient temperatures up to 25 °C. For other conditions please confer with us.

Each RSC type can be applied both as vacuum pump and compressor in continuous operation over the total stated performance curve range. The motors are available as standard for the input voltage range of 50 and 60 Hz and for protection category IP 55 as well as approved for UL and CSA.



Madan Technologies  
Maagan Michael  
D. N. Menashe  
3780500 Israel

Tel: +972-4-6243353  
Fax: +972-4-6243366  
sales@madantec.com  
www.madantec.com

# RENOVA

## 1RSC 61-100

Curve No.	Model	Freq. (Hz)	Rated power (KW)	Voltage (V)	Current (A)	Sound Level [dB(A)]	Weight (Kg)
1	1RSC61-100 15T	50	15.0	345-415Δ / 600-720Y	35.0Δ / 20.0Y	75	187
A	1RSC61-100 15T	60	17.5	380-480Δ / 660-720Y	36.5Δ / 21.0Y	84	187
2	1RSC61-100 20T	50	20.0	345-415Δ / 600-720Y	40.0Δ / 23.0Y	75	212
B	1RSC61-100 20T	60	23.0	380-480Δ / 660-720Y	42.0Δ / 24.2Y	84	212
3	1RSC61-100 25T	50	25.0	345-415Δ / 600-720Y	52.0Δ / 30.0Y	75	219
C	1RSC61-100 25T	60	29.0	380-480Δ / 660-720Y	52.0Δ / 30.0Y	84	219

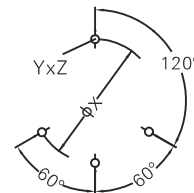
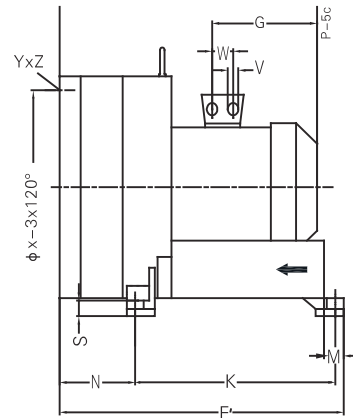
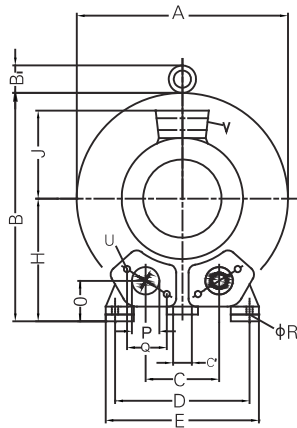
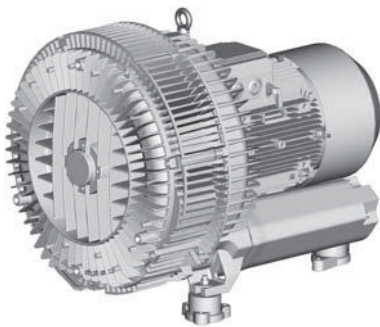

Model	A	B	C	D	E	F'	G	H	J	K	M	N	O	ØP
1RSC61-100 15T	615	663	207	360	415	786	345	350	197	533	39	230	132	4"
1RSC61-100 20T	615	663	207	360	415	786	345	350	197	533	39	230	132	4"
1RSC61-100 25T	615	663	207	360	415	786	345	350	197	533	39	230	132	4"

Model	Q	ØR	S	U	V	ØX	YxZ	X-Holes
1RSC61-100 15T	140	15	79	M12x35	4xM40x1.5	490	M12x30	0°/120°/240°
1RSC61-100 20T	140	15	79	M12x35	4xM40x1.5	490	M12x30	0°/120°/240°
1RSC61-100 25T	140	15	79	M12x35	4xM40x1.5	490	M12x30	0°/120°/240°