

Prisma 35N/45N **Surface horizontal**



Centrifugal multistage pump for water supply

Applications

Pumping of clean water for domestic, industrial, agricultural and gardening purposes.
Silent.
Self-priming up to 2m.

Materials

Pump body and impellers in AISI 304.
Pump shaft in AISI 431.
Diffusers in technopolymer.
Suction and discharge in cast iron.
Mechanical seal.
Motor casing in aluminium.
O-rings in NBR.

Equipment

No cable.

Motor

Asynchronous 2 poles.
IP 55 protection.
Class F insulation.
Single phase motor with built-in thermal protection.
Continuous operation.

Limitations

Maximum water temperature: 40° C.



Hydraulic performance table

| Model | I [A] | | | P1 [kW] | | P2 | | c [μF] | l/ min m³/h | 20 | 40 | 60 | 80 | 100 | 120 | 140 | 150 | Code | |
|--------------|--------|--------|--------|---------|-----|------|------|--------|----------------|-----|-----|-----|-----|-----|-----|-----|-----|--------|-------------|
| | 1~230V | 3~230V | 3~400V | 1~ | 3~ | [kW] | [HP] | | | 1,2 | 2,4 | 3,6 | 4,8 | 6,0 | 7,2 | 8,4 | 9,0 | 1~230V | 3~230V/400V |
| Prisma 35 3N | 6,7 | 4,5 | 2,6 | 1,5 | 1,4 | 0,75 | 1 | 25 | mwc | 41 | 39 | 36 | 34 | 31 | 27 | 22 | 18 | 129343 | 129346 |
| Prisma 35 4N | 8,4 | 5,3 | 3,1 | 1,8 | 1,8 | 1,1 | 1,5 | 25 | | 54 | 51 | 48 | 44 | 39 | 33 | 27 | 23 | 129344 | 129347 |
| Prisma 35 5N | 10,2 | 6,9 | 4 | 2,3 | 2,2 | 1,5 | 2 | 30 | | 68 | 64 | 60 | 55 | 49 | 41 | 34 | 30 | 129345 | 129348 |
| Prisma 35 6N | - | 8,3 | 4,8 | - | 2,7 | 2,2 | 3 | - | | 81 | 78 | 74 | 67 | 60 | 52 | 42 | 37 | - | 129349 |

| Model | I [A] | | | P1 [kW] | | P2 | | c [μF] | l/ min m³/h | 25 | 50 | 75 | 100 | 125 | 150 | 200 | 250 | Code | |
|--------------|--------|--------|--------|---------|-----|------|------|--------|----------------|-----|-----|-----|-----|-----|-----|-----|-----|--------|-------------|
| | 1~230V | 3~230V | 3~400V | 1~ | 3~ | [kW] | [HP] | | | 1,5 | 3,0 | 4,5 | 6,0 | 7,5 | 9,0 | 12 | 15 | 1~230V | 3~230V/400V |
| Prisma 45 3N | 7,9 | 5,2 | 3 | 1,8 | 1,7 | 1,1 | 1,5 | 25 | mwc | 37 | 36 | 35 | 33 | 30 | 27 | 18 | 8 | 132082 | 132084 |
| Prisma 45 4N | 10 | 6,9 | 4 | 2,2 | 2,2 | 1,5 | 2 | 30 | | 48 | 47 | 45 | 42 | 39 | 36 | 24 | 11 | 132083 | 132085 |
| Prisma 45 5N | - | 8,6 | 5 | - | 2,8 | 2,2 | 3 | - | | 61 | 59 | 56 | 54 | 50 | 45 | 31 | 15 | - | 132086 |

Prisma 35N/45N Surface horizontal



Dimension and weight

Prisma 35N

| Model | A | B | C | D | E | F | G | H | I | J | K | Kg |
|--------------|-----|-----|--------|-----|--------|-----|-----|-----|----|----|----|-----------|
| Prisma 35 3N | 221 | 187 | 1 1/4" | 147 | 1 1/4" | 282 | 158 | 125 | 90 | 60 | 12 | 18,5 |
| Prisma 35 4N | 247 | 212 | 1 1/4" | 147 | 1 1/4" | 282 | 158 | 125 | 90 | 60 | 12 | 20,5/18,6 |
| Prisma 35 5N | 271 | 236 | 1 1/4" | 147 | 1 1/4" | 282 | 158 | 125 | 90 | 60 | 12 | 23,5/20,6 |
| Prisma 35 6N | 296 | 261 | 1 1/4" | 147 | 1 1/4" | 282 | 158 | 125 | 90 | 60 | 12 | 23,7 |

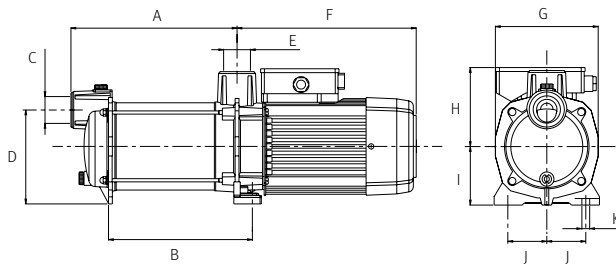

Prisma 45N

| Model | A | B | C | D | E | F | G | H | I | J | K | Kg |
|--------------|-----|-----|--------|-----|--------|-----|-----|-----|----|----|----|-----------|
| Prisma 45 3N | 246 | 212 | 1 1/2" | 152 | 1 1/4" | 282 | 158 | 125 | 90 | 60 | 12 | 22,6/18,6 |
| Prisma 45 4N | 277 | 242 | 1 1/2" | 152 | 1 1/4" | 282 | 158 | 125 | 90 | 60 | 12 | 23,7/21,2 |
| Prisma 45 5N | 307 | 273 | 1 1/2" | 152 | 1 1/4" | 282 | 158 | 125 | 90 | 60 | 12 | 25,3 |

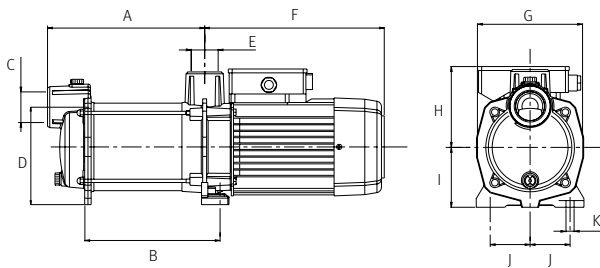

Performance curve at 2900 rpm

Prisma 35N

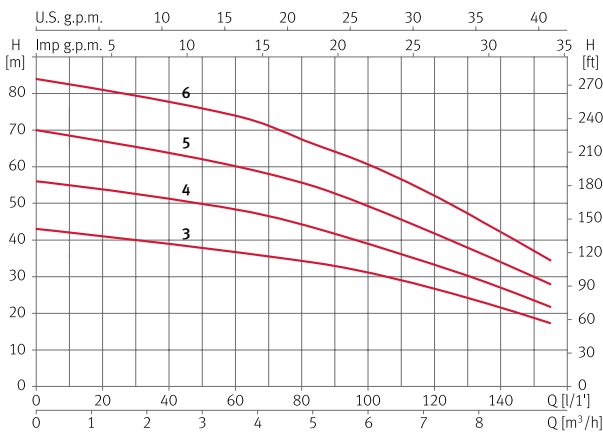

Prisma 45N

